

DRAFT PLAN OF SUBDIVISION
23T-20201

DATE: SEPTEMBER 20, 2021 SCALE 1:1,000
 PROJECT No. 1841 DRAWN BY: A.R.N.

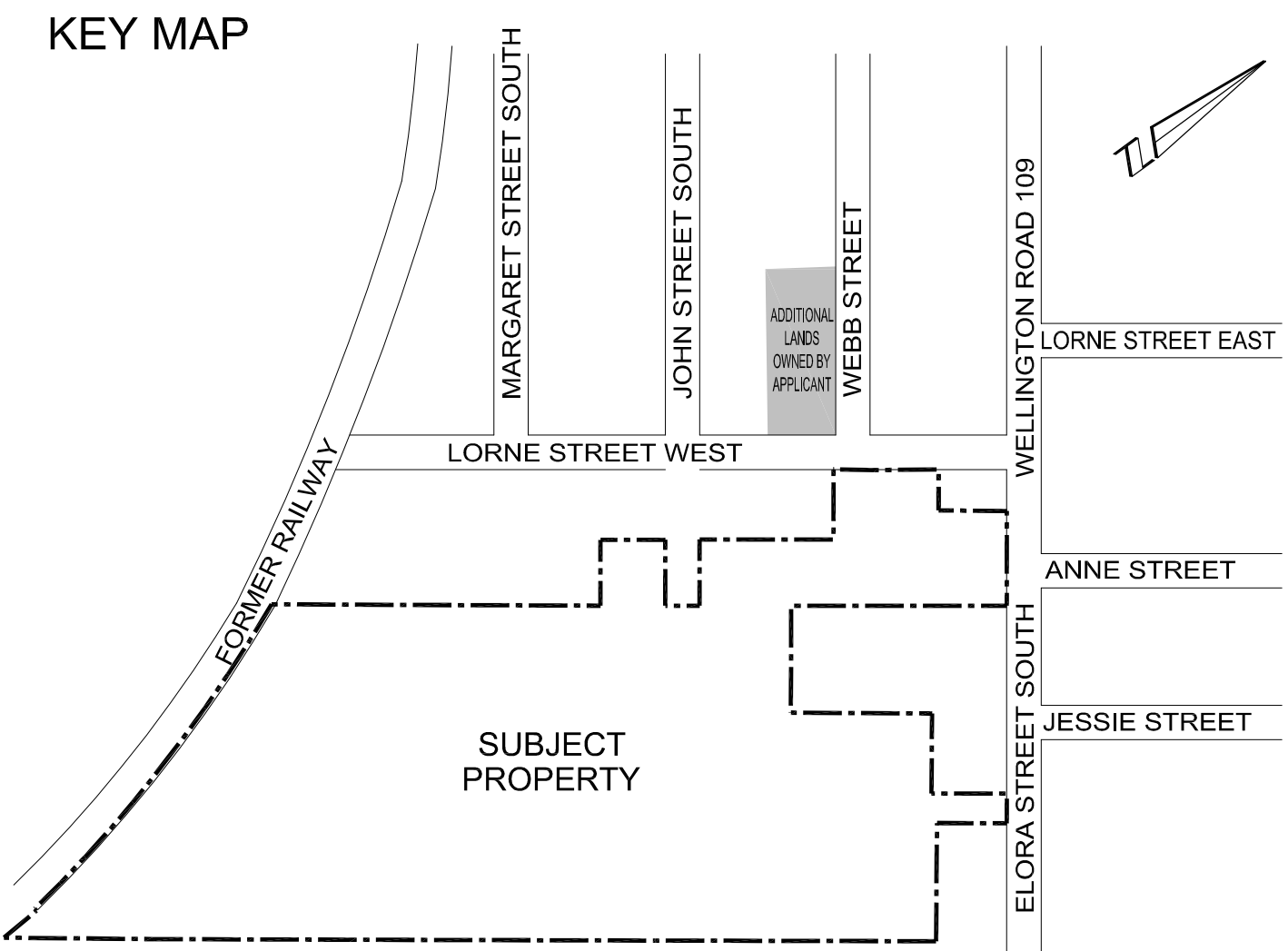

LEGAL DESCRIPTION
 PART OF LOT 88, CONCESSION "D" (MINTO)
 PART OF PARK LOTS E & F PRESTON'S SURVEY "D", (MINTO)
 (TOWN OF HARRISTON)
 PART OF LOT 88, CONCESSION "D"
 (GEOGRAPHIC TOWNSHIP OF MINTO)
 TOWN OF MINTO
 COUNTY OF WELLINGTON

NOTES
 1. TOPOGRAPHIC INFORMATION PROVIDED BY AUTOMATED ENGINEERING TECHNOLOGIES LTD.

ADDITIONAL INFORMATION
 (UNDER SECTION 51(17) OF THE PLANNING ACT)
 INFORMATION REQUIRED BY CLAUSES a,b,c,d,e,f,g,j and I ARE AS SHOWN ON DRAFT PLAN.
 h) municipal water supply
 i) sand and gravel
 k) municipal sanitary and storm sewers

LAND USE SCHEDULE

DESCRIPTION	LOTS/BLOCKS	UNITS	AREA (ha.)
SINGLE DETACHED	14-55,60-71	57	2,940
SEMI-DETACHED	46-59,72	30	0,624
TOWNHOUSE	73-78	39	1,133
STORMWATER MANAGEMENT	79		0,494
OPEN SPACE	80		2,227
PARK	81,85		0,206
FUTURE DEVELOPMENT	82,83		0,255
WALKWAY	84		0,071
ROADS			2,422
TOTAL	85	126	10,369

OWNER'S CERTIFICATE
 I, HEREBY AUTHORIZE ASTRID J. CLOS, PLANNING CONSULTANTS TO PREPARE AND SUBMIT THIS DRAFT PLAN OF SUBDIVISION.

Jerry Roubos
 JERRY ROUBOS
 MEX DEVELOPMENTS INC.

FEBRUARY 12, 2020
 DATE

SURVEYOR'S CERTIFICATE
 I CERTIFY THAT THE BOUNDARIES OF THE LAND TO BE SUBDIVIDED AND THEIR RELATIONSHIP TO THE ADJACENT LANDS ARE CORRECTLY SHOWN.

Greg Ford
 GREG FORD, O.S.
 Wilson Ford Surveying Inc.

FEBRUARY 12, 2020
 DATE

