

**DRAFT PLAN OF SUBDIVISION**

DATE: FEBRUARY 3, 2020 SCALE 1:1,000  
 PROJECT No. 1841 DRAWN BY: A.R.N.

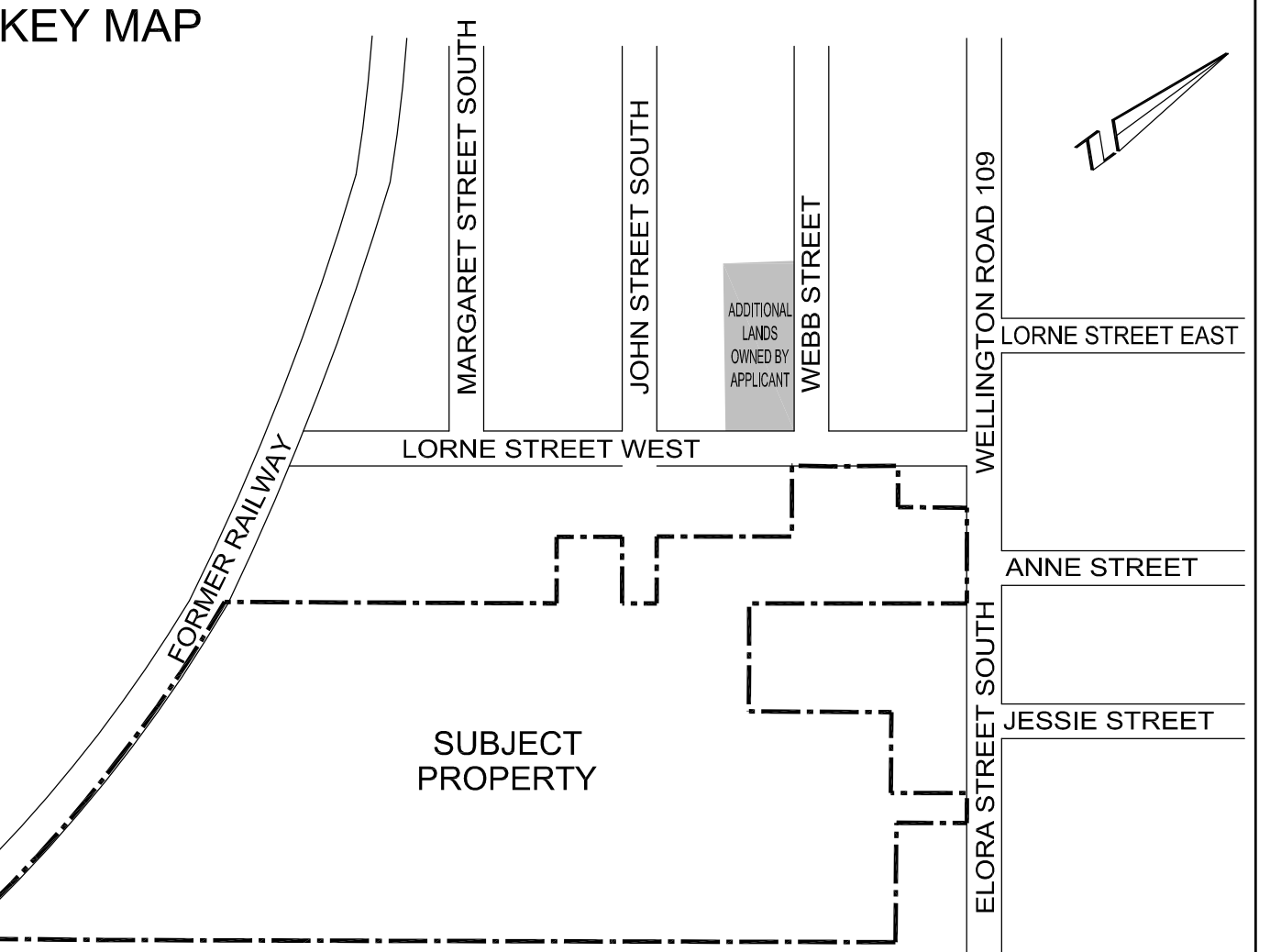

**LEGAL DESCRIPTION**  
 PART OF LOT 88, CONCESSION "D" (MINTO)  
 PART OF PARK LOTS E & F PRESTON'S SURVEY "D", (MINTO)  
 (TOWN OF HARRISTON)  
 PART OF LOT 88, CONCESSION "D"  
 (GEOGRAPHIC TOWNSHIP OF MINTO)  
 TOWN OF MINTO  
 COUNTY OF WELLINGTON

**NOTES**  
 1. TOPOGRAPHIC INFORMATION PROVIDED BY AUTOMATED ENGINEERING TECHNOLOGIES LTD.

**ADDITIONAL INFORMATION**  
 (UNDER SECTION 51(17) OF THE PLANNING ACT)  
 INFORMATION REQUIRED BY CLAUSES a,b,c,d,e,f,g,j and l ARE AS SHOWN ON DRAFT PLAN.  
 h) municipal water supply  
 i) sand and gravel  
 k) municipal sanitary and storm sewers

**LAND USE SCHEDULE**

DESCRIPTION	LOTS/BLOCKS	UNITS	AREA (ha.)
SINGLE DETACHED	1-47,57-69,72-77	66	2,958
SEM-DETACHED	48-56,70,71	22	0,731
TOWNHOUSE	78-83	40	1,142
STORMWATER MANAGEMENT	84		0,374
OPEN SPACE	85		2,345
PARK	86		0,170
FUTURE DEVELOPMENT	87		0,049
ROADS			2,600
<b>TOTAL</b>	<b>87</b>	<b>128</b>	<b>10,369</b>

**OWNER'S CERTIFICATE**  
 I, HEREBY AUTHORIZE ASTRID J. CLOS, PLANNING CONSULTANTS TO PREPARE AND SUBMIT THIS DRAFT PLAN OF SUBDIVISION.

*Jerry Roubos*  
 JERRY ROUBOS  
 MEX DEVELOPMENTS INC.  
 FEBRUARY 12, 2020  
 DATE

**SURVEYOR'S CERTIFICATE**  
 I CERTIFY THAT THE BOUNDARIES OF THE LAND TO BE SUBDIVIDED AND THEIR RELATIONSHIP TO THE ADJACENT LANDS ARE CORRECTLY SHOWN.

*Greg Ford*  
 GREG FORD, O.S.  
 Wilson Ford Surveying Inc.  
 FEBRUARY 12, 2020  
 DATE

